

STUDENT RECREATION + WELLNESS CENTER

COMMUNITY ENGAGEMENT MEETING

11.02.2022

MICHIGAN STATE
UNIVERSITY



MOODY•NOLAN + ROSSETTI





01

WELCOME

INTRODUCTIONS

MICHIGAN STATE UNIVERSITY

STUDENT LIFE & ENGAGEMENT

Senior Vice President of SLE and Project Sponsor

Recreational Sports and Fitness Services

INFRASTRUCTURE, PLANNING, & FACILITIES

Planning, Design, & Construction

DESIGN TEAM

MOODY NOLAN | Design Architect

ROSSETTI | Architect of Record

ARUP | Structural Engineer

BECKETT & RAEDER | Landscape Architect

FISHBECK | Civil Engineer

PETER BASSO & ASSOC. | Mechanical, Electrical, Plumbing Engineer

CONSTRUCTION MANAGER

GRANGER CONSTRUCTION | CM



ROSSETTI

ARUP



GRANGER

PURPOSE

BOARD OF TRUSTEES AUTHORIZATION

BACKGROUND

- Existing recreation facilities are 40 – 100 years old and lack amenities that students desire.
- Previous funding model struggled to meet student needs.
- Student governance recommended and the Board of Trustees approved a student recreational fee.
- Focus on overall student health and wellness.

PROJECT DESCRIPTION

- New recreation and wellness center will replace the current IM West with a modern structure and facilities
- Address current student recreation and fitness needs with an eye towards future development
- Located at the SE corner of Harrison and Shaw Lane (former Cherry Lane and “Faculty Bricks” site)

STUDENT RECREATION + WELLNESS CENTER

IMPLEMENTATION MASTER PLAN

1. Service Road Fields
2. Student Recreation + Wellness Center
3. IM West Demolition and Remediation
4. IM East Renovations
5. Future Outdoor Fields

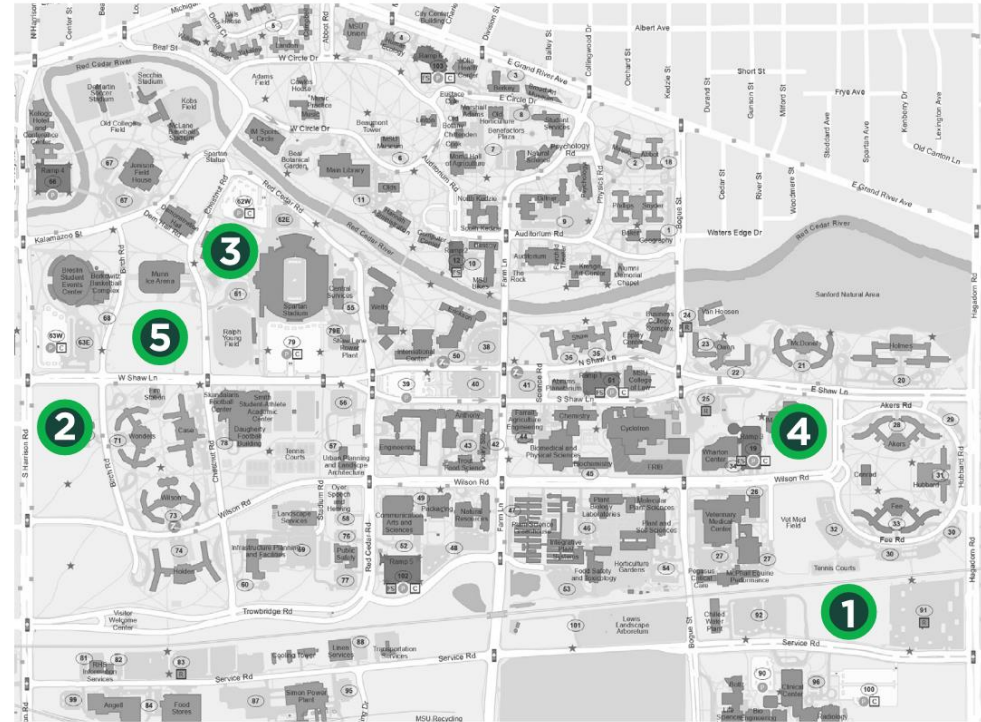

STUDENT RECREATION + WELLNESS CENTER

KEY FACTS

- Design focused on recreation and well-being for all Spartans
- Approx. 287,000 SF
- 2 story + mezzanine building
- Implementation of sustainable practices
 - Reduced energy loads
 - Water conservation measures
 - Reduction of embodied and operational carbon
 - Passive design strategies

STUDENT RECREATION + WELLNESS CENTER

PROGRAM ELEMENTS

FITNESS + EXERCISE

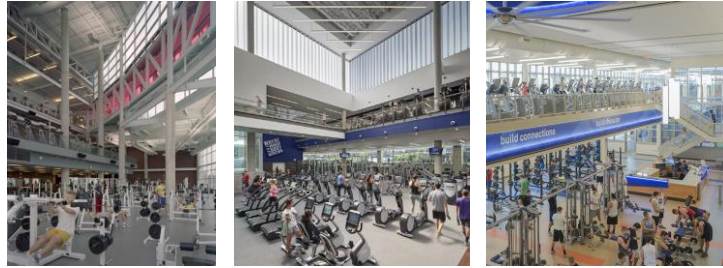

GYMNASIUM + JOGGING TRACK

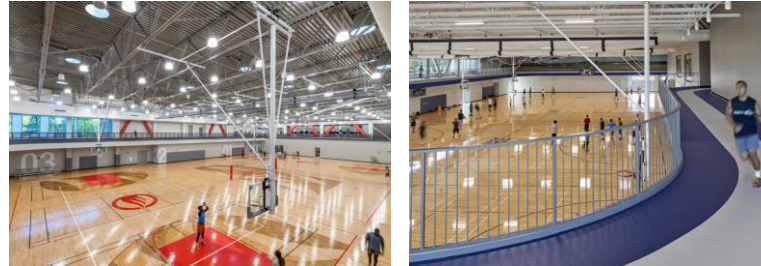

MULTI- PURPOSE

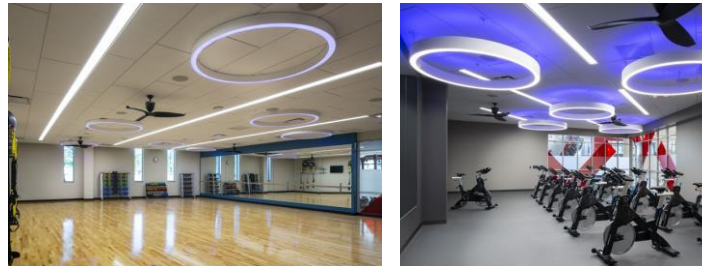

STUDENT RECREATION + WELLNESS CENTER

PROGRAM ELEMENTS

M.A.C. + TURF



CLIMBING + BOULDERING



WELLNESS SUITE



PROJECT PRIORITIES

GUIDING PRINCIPLES

1. In support of **DIVERSITY, EQUITY, INCLUSION, AND BELONGING**, the facility will invigorate a new model for student well-being that is welcoming to all individuals from all backgrounds and communities in support of their lifelong healthy habits.
2. The facility will support **STUDENT, STAFF AND FACULTY SUCCESS** through an inclusive environment, with the social and wellness support that enables all students to learn, thrive and succeed after graduation, and will contribute to attracting and keeping talent and create conditions where staff and faculty can do their best work.
3. By taking a **HOLISTIC AND SUSTAINABLE APPROACH** to health and well-being that is focused on people, communities, partnerships and innovative thinking, the facility will help people to achieve their full potential.
4. The facility will **INTEGRATE NATURE** year-round to connect indoors and outdoors, showcasing the university's campus-wide arboretum.
5. Leveraging **HIGH-PERFORMANCE DESIGN** to balance embodied and operational carbon to showcase environmental stewardship, the facility will do its part to address the global climate crisis within our community.
6. The facility will create a **GATEWAY BUILDING** that connects campus and the community, establishing a new west campus entry and core of student activity.
7. The facility will establish flexible and future-proof **ZONES OF DISCOVERY** that intersect recreation, well-being, and technology to maximize growth opportunities.





02

DESIGN

SCHEMATIC PLANS

POTENTIAL
FUTURE PHASE



POTENTIAL
FUTURE PHASE

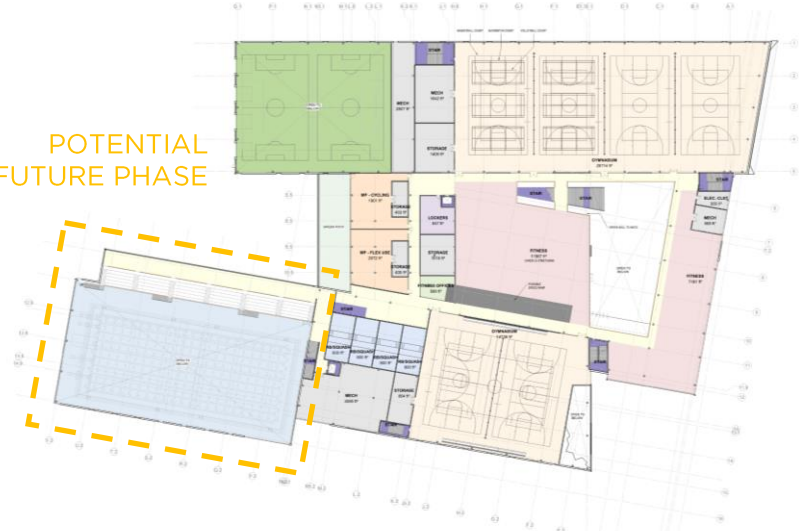

POTENTIAL
FUTURE PHASE



POTENTIAL
FUTURE PHASE

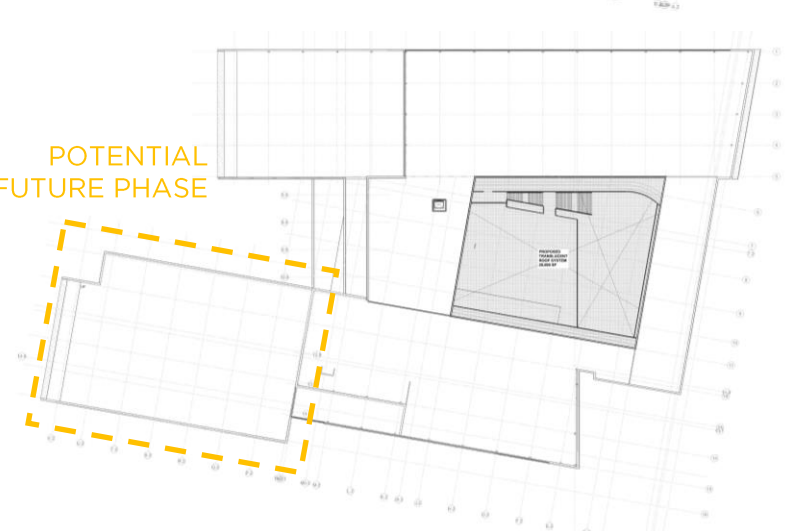



NORTH

POTENTIAL
FUTURE PHASE

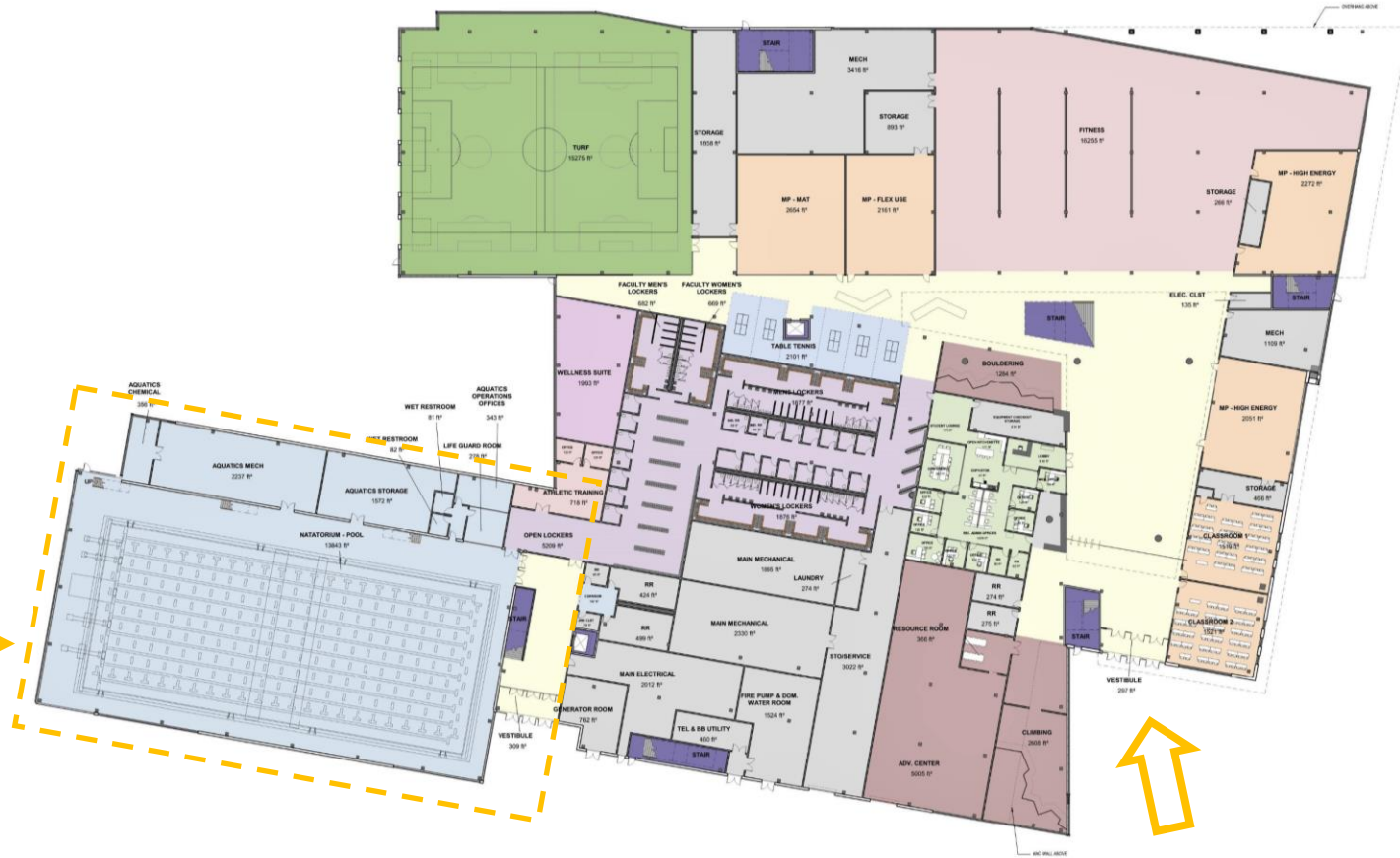

LEVEL 01 - FIRST FLOOR PLAN



NORTH

POTENTIAL
FUTURE PHASE



LEVEL 02 - SECOND FLOOR PLAN



NORTH

POTENTIAL
FUTURE PHASE

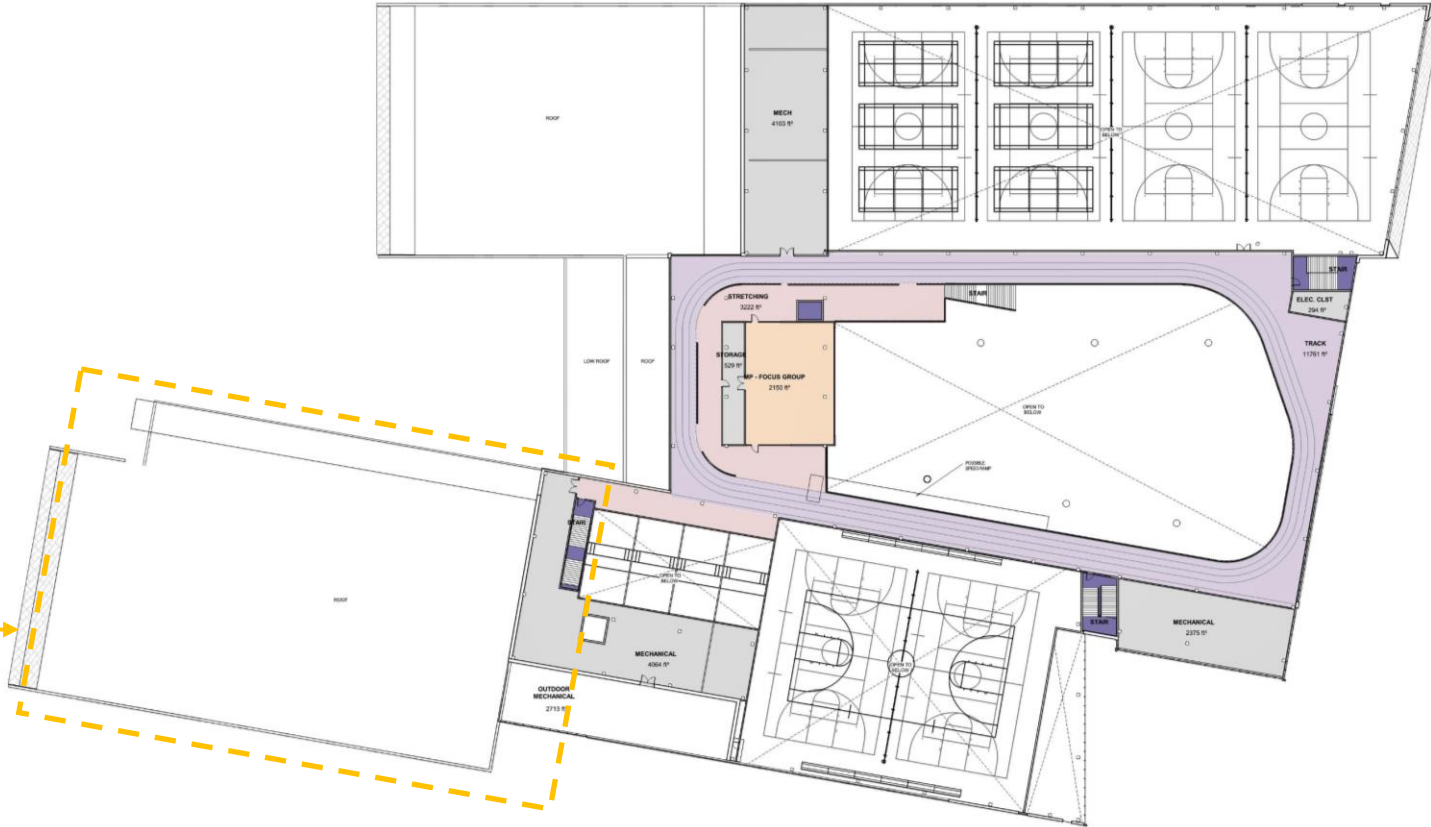

LEVEL 03 - MEZZANINE PLAN

HARRISON RD.

SITE PLAN

OUTDOOR FUNCTIONAL FITNESS

RAIN GARDEN

SHAW LN.

POTENTIAL FUTURE PHASE

RAIN GARDEN

ENTRY

LOADING

BARRIER-FREE PARKING

BIRCH RD.



SITE SECTION

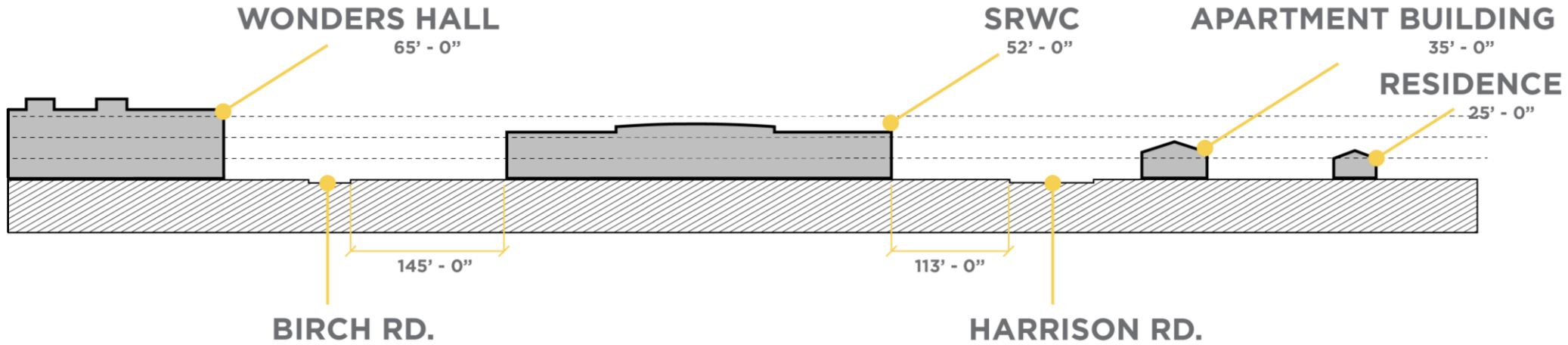

EXTERIOR PALLETE - SOLID



CEMENTITIOUS STONE PANEL

BRICK / MASONRY

WOOD PANEL FINISH



EXTERIOR PALLETE - TRANSLUCENT

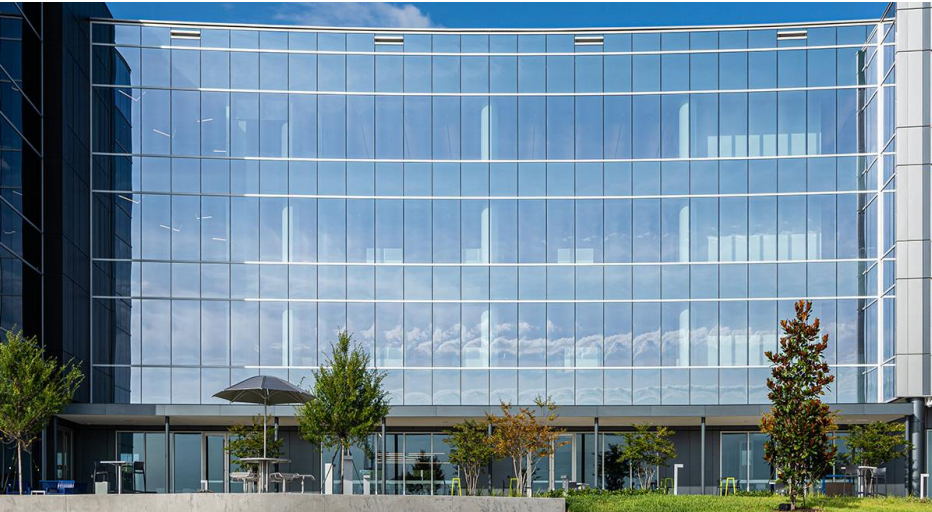

CLEAR GLASS

GREEN CERAMIC FRIT GLASS

**TRANSLUCENT
GLAZING SYSTEM**





POTENTIAL
FUTURE PHASE

SCHEMATIC 3D REPRESENTATION



SCHEMATIC 3D REPRESENTATION



SCHEMATIC 3D REPRESENTATION



POTENTIAL
FUTURE PHASE

SCHEMATIC 3D REPRESENTATION

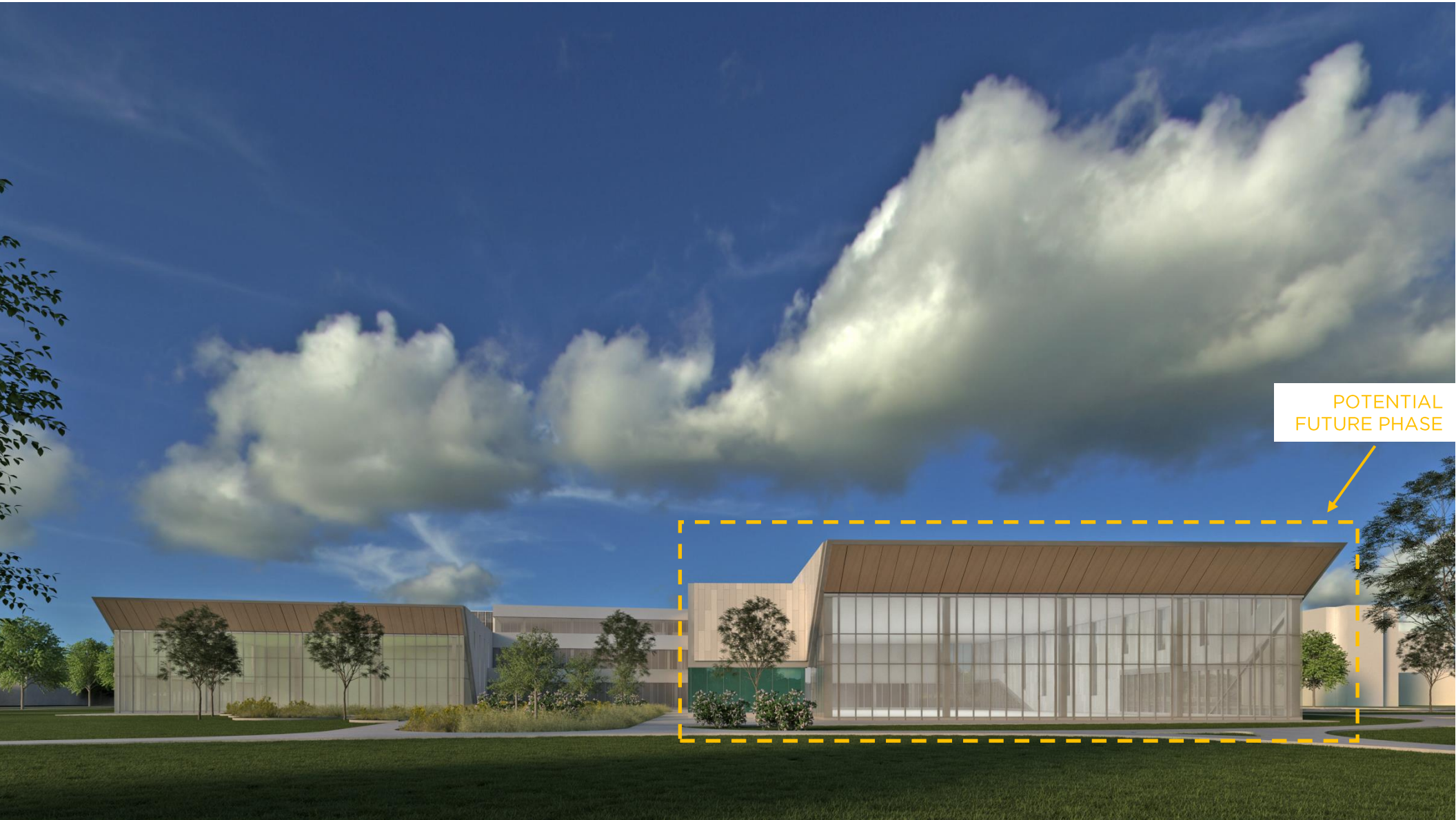

POTENTIAL
FUTURE PHASE

SCHEMATIC 3D REPRESENTATION



POTENTIAL
FUTURE PHASE

SCHEMATIC 3D REPRESENTATION

QUESTIONS?

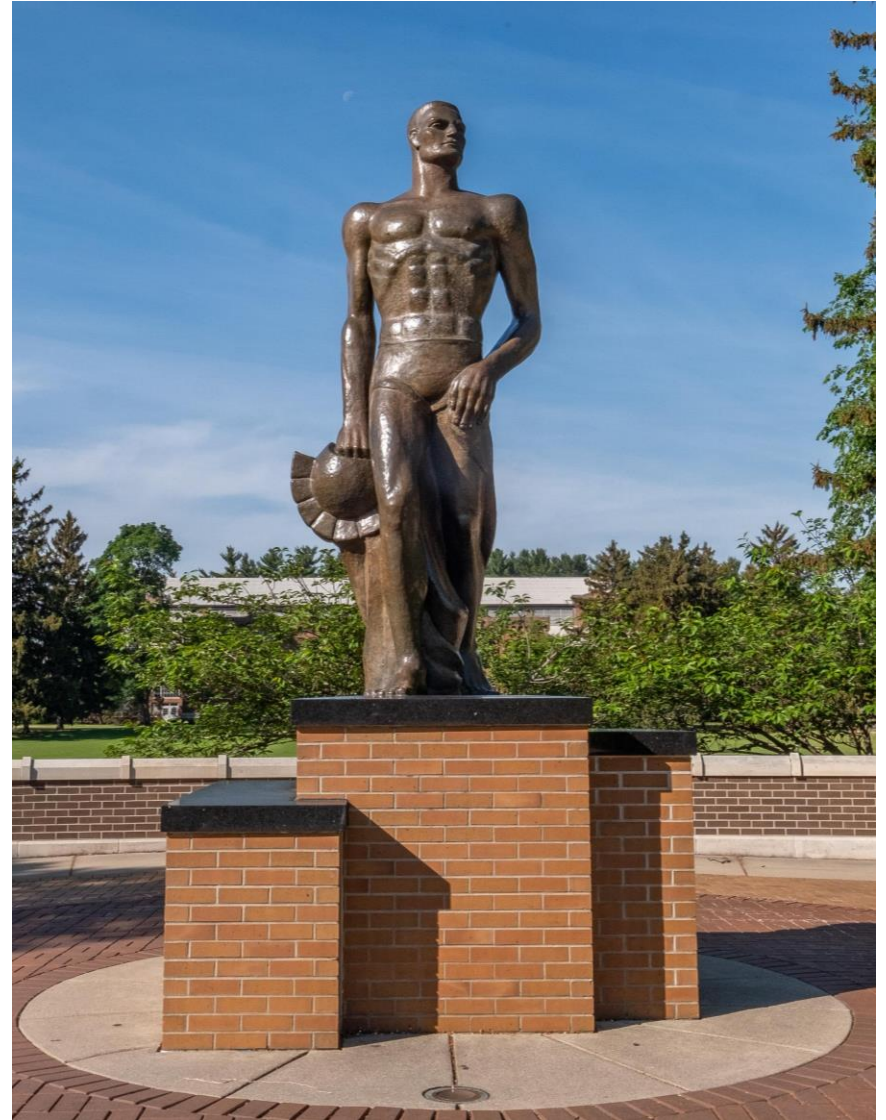

THANK YOU

MICHIGAN STATE
UNIVERSITY



MOODY•NOLAN + **ROSSETTI**